

Datasheet for #sb525 DN

Recommendations:

Please read the starter kit user manual (at least installation chapter 5), if available, and have a look at the FAQ at <http://www.alpeslasers.ch/alfaqa.pdf>

WARNING: Operating the laser with longer pulses, shorter period, or higher voltage or current than specified in this document may cause damage and will result in loss of warranty, unless agreed upon with Alpes Lasers!

WARNING: Beware of the polarity of the laser. This laser has to be powered with negative bias on the laser contact (= bonding pad, corresponding to the label "laser" on the LLH) and the positive bias on the base contact (= submount, corresponding to the label "base" on the LLH).

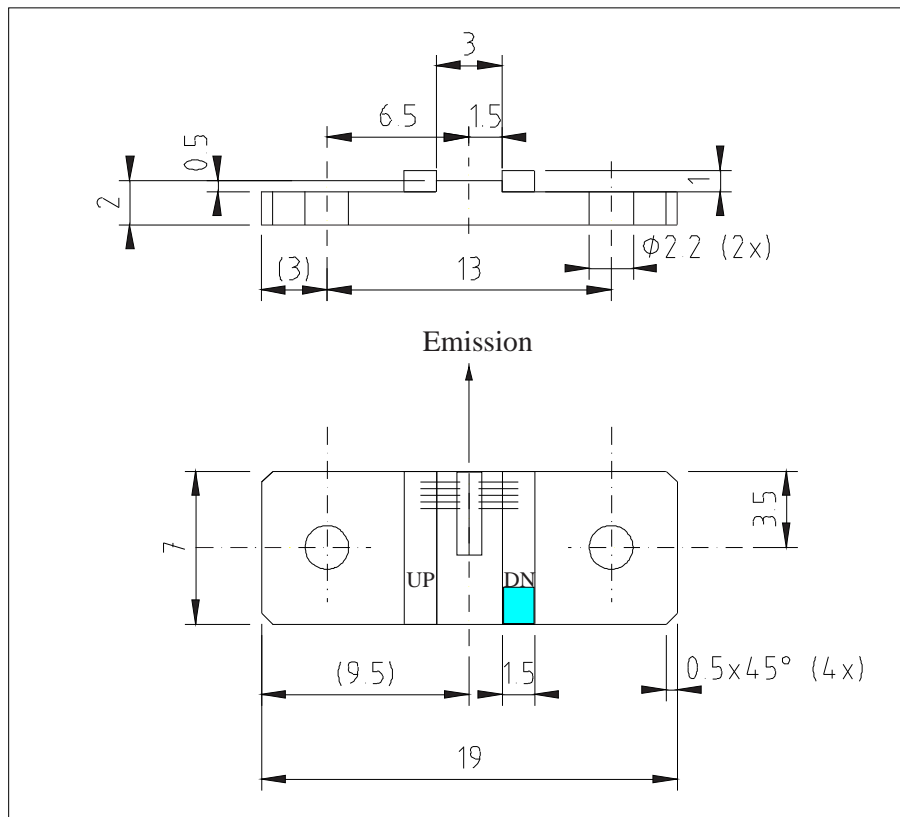

Figure 1: Support mounting for #sb525 DN (please note that the laser is connected to the DN pad drawn in blue)

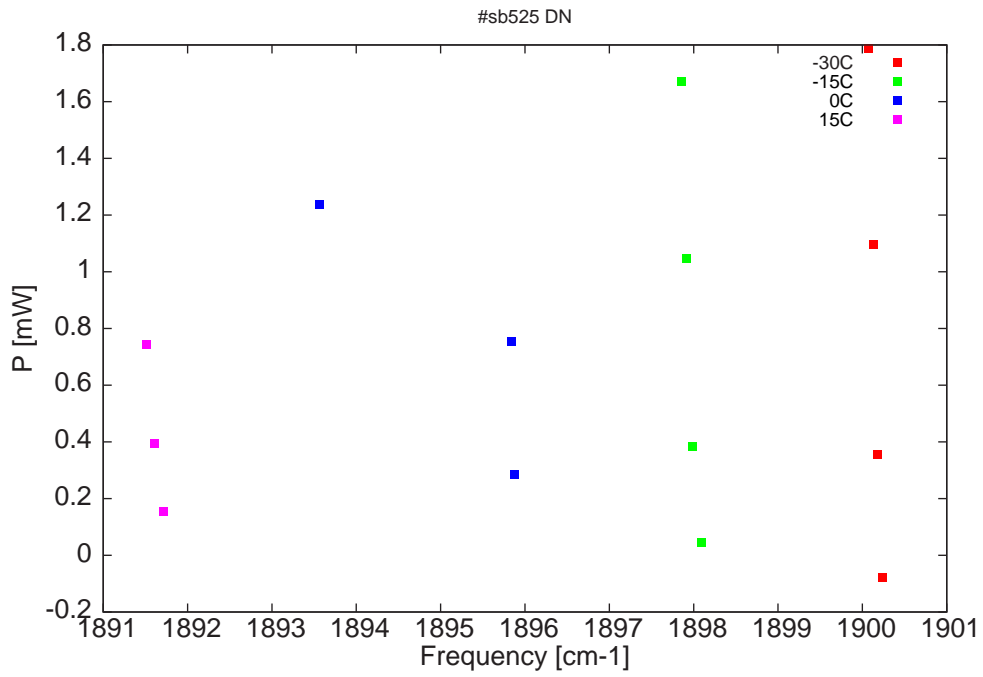

Figure 2: Output power as a function of the singlemode emission frequencies and temperatures

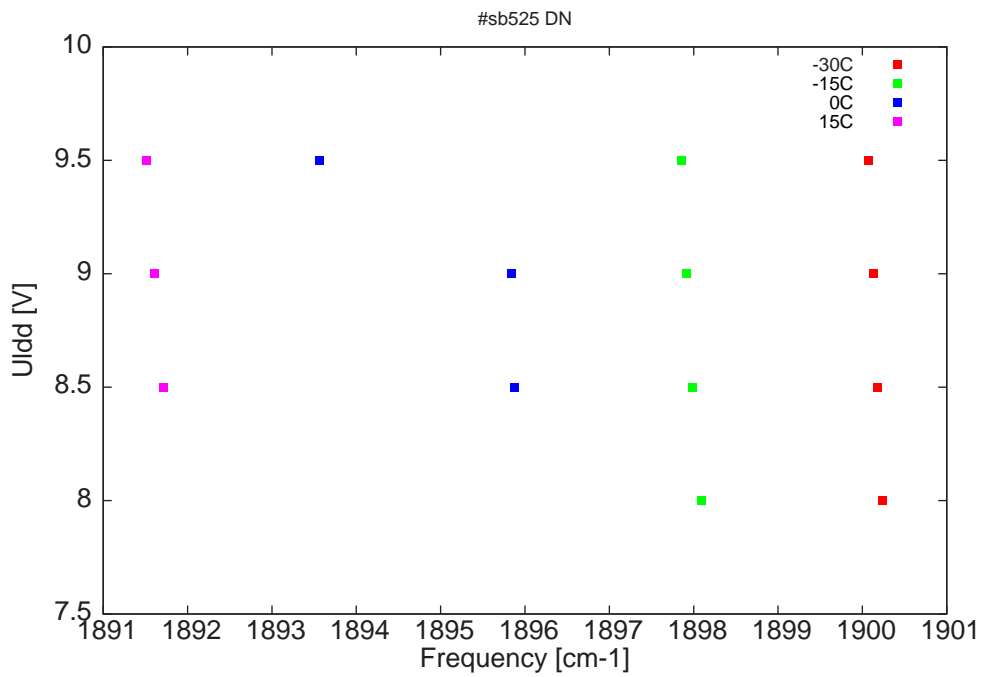

Figure 3: DC voltage fed to LDD (U_{ldd}) as a function of the singlemode emission frequencies and temperatures

λ [nm]	ν [cm ⁻¹]	P[mW]	Temp[°C]	U_{LDD} [V]	I_{pulse} [A]
5262.5	1900.2	-0.1	-30	8	0.32
5262.7	1900.2	0.4	-30	8.5	0.41
5262.8	1900.1	1.1	-30	9	0.52
5263	1900.1	1.8	-30	9.5	0.57
5268.5	1898.1	0	-15	8	0.34
5268.8	1898	0.4	-15	8.5	0.42
5268.9	1897.9	1	-15	9	0.5
5269.1	1897.9	1.7	-15	9.5	0.58
5274.6	1895.9	0.3	0	8.5	0.44
5274.7	1895.8	0.8	0	9	0.51
5281.1	1893.6	1.2	0	9.5	0.59
5286.2	1891.7	0.2	15	8.5	0.42
5286.5	1891.6	0.4	15	9	0.5
5286.8	1891.5	0.7	15	9.5	0.56

Table 1 : singlemode optical output power as function of operating parameters

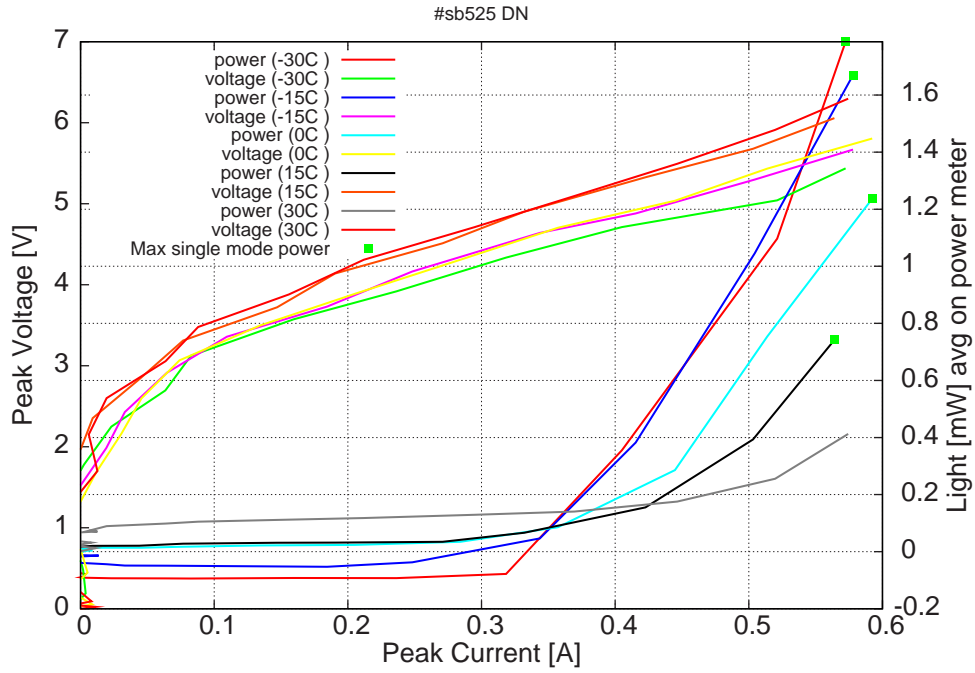

Figure 4: peak voltage and average power vs peak current at 2% dc (the solid squares indicate the maximum singlemode emitted power)

Note: data taken with 50ns pulses, 2.5 μ s period.

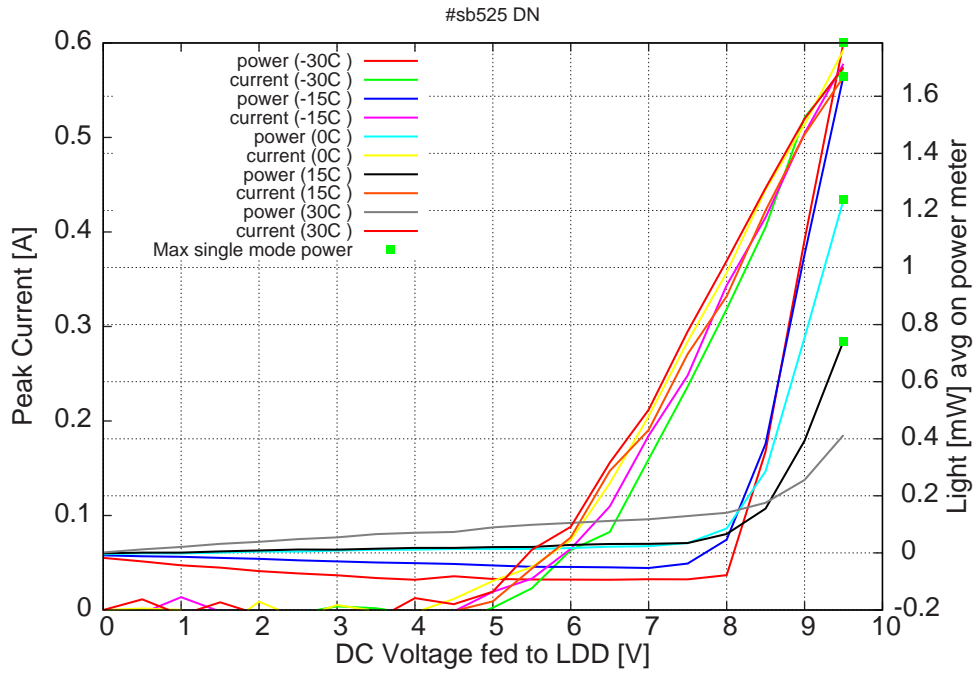

Figure 5: peak current and average power vs LDD voltage at 2% dc (the solid squares indicate the maximum singlemode emitted power)

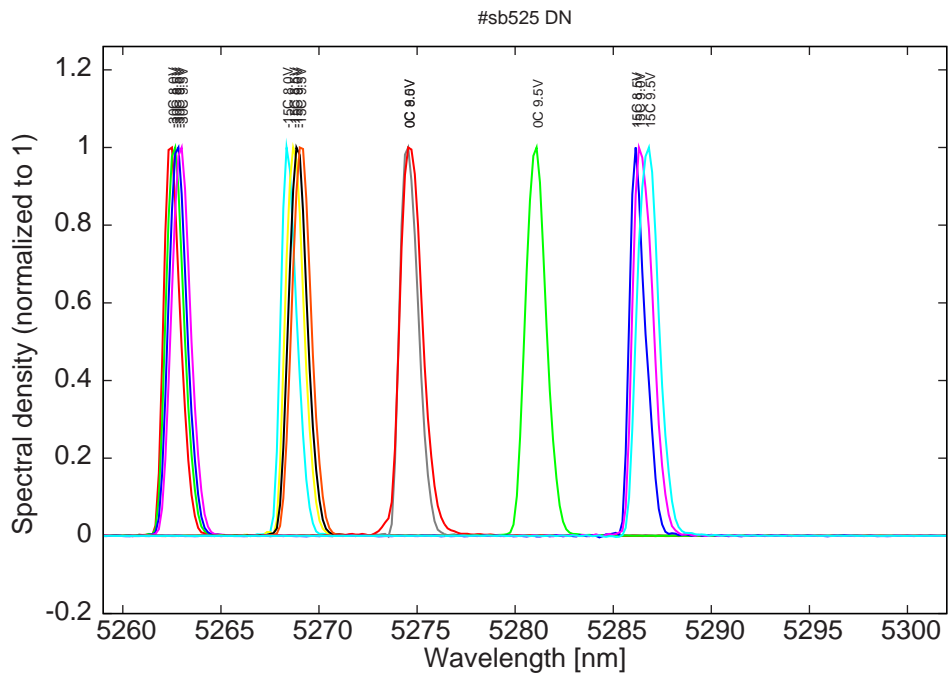

Figure 6: spectra at -30C, -15C, 0C, and 15C at 2% dc for various LDD voltages

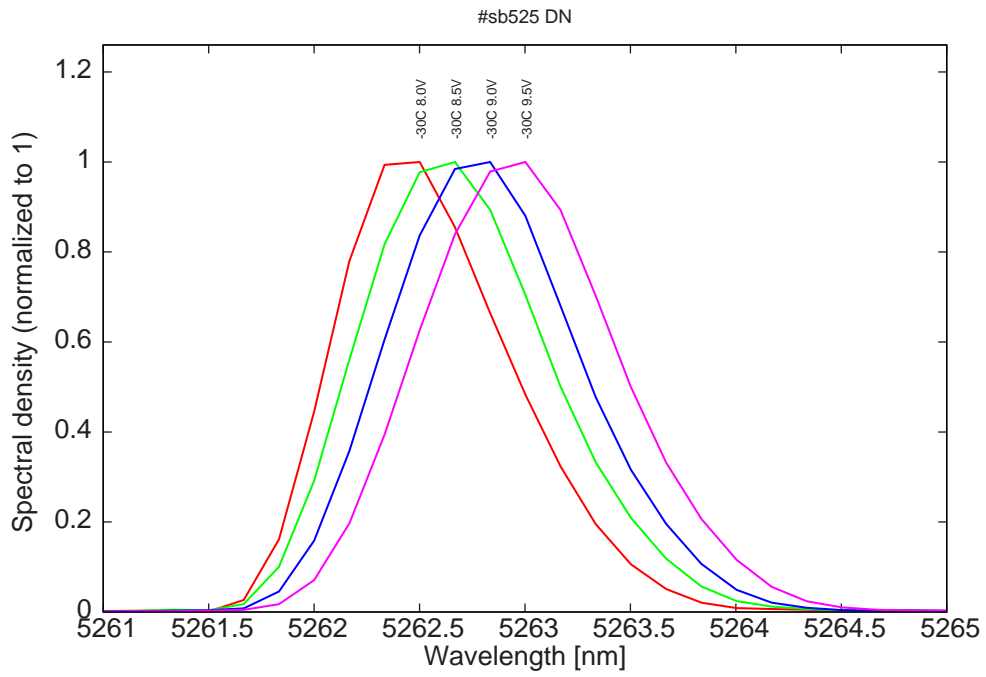

Figure 7: spectra at -30C for various LDD voltages

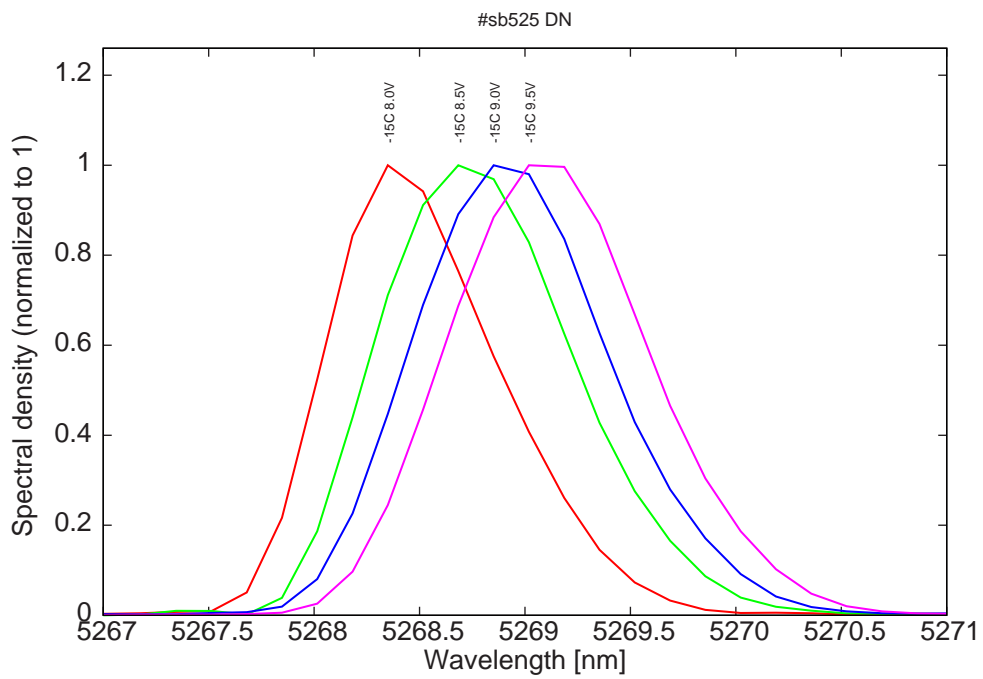

Figure 8: spectra at -15C for various LDD voltages

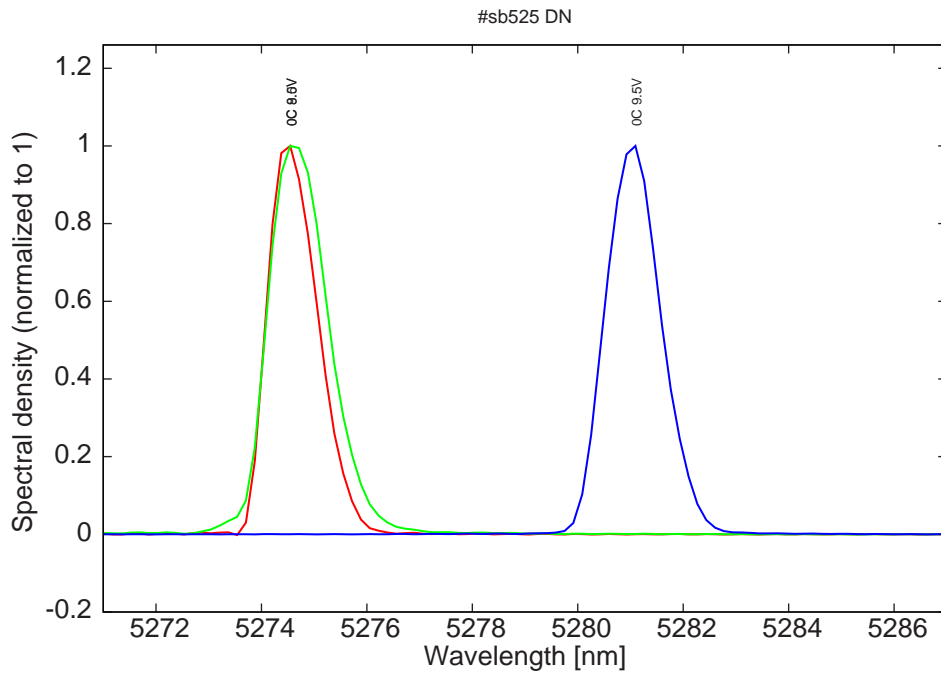

Figure 9: spectra at 0C for various LDD voltages (mode jumping at 0C and 9.5V)

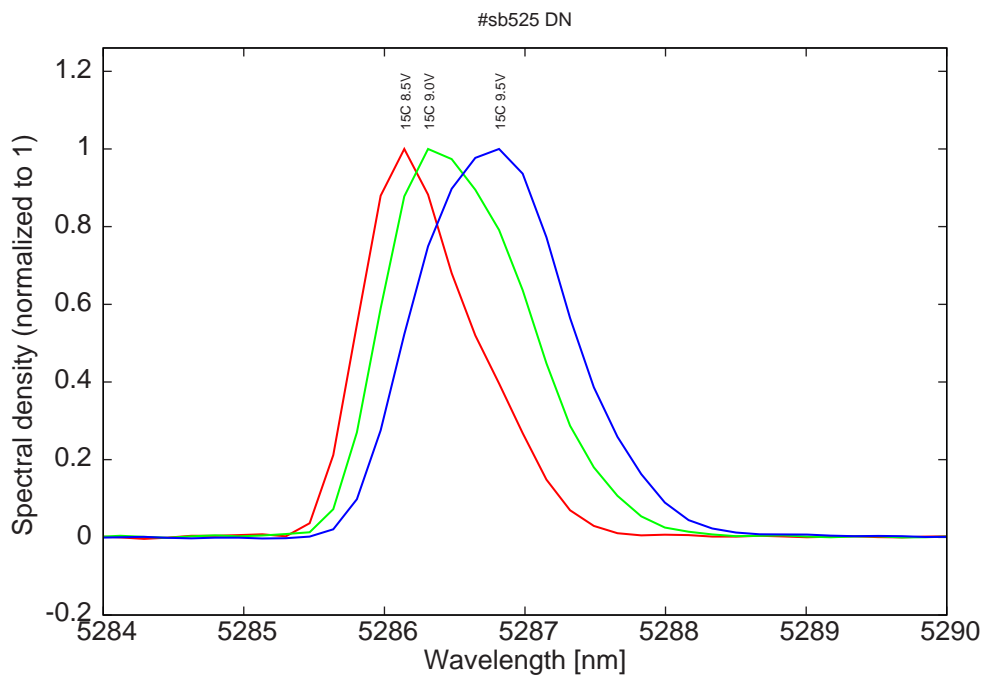

Figure 10: spectra at 15C for various LDD voltages (same mode as 0C and 9.5V)